

HFE6

HIGH POWER LATCHING RELAY

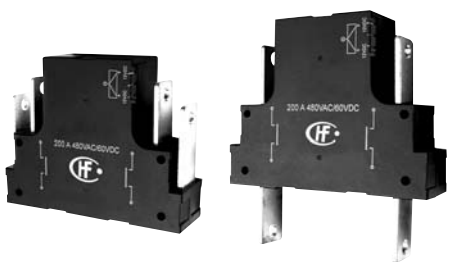

Features

- Latching relay
- 200A switching capability
- Strong resistance ability to shock & vibration
- Heavy load up to 55.4kVA
- 4kV dielectric strength (between coil and contacts)
- Typical application: Power, Lamp
- Environmental friendly product (RoHS compliant)
- Outline Dimensions: (100.0 x 80.0 x 29.8) mm

CONTACT DATA

Contact arrangement	2A, 2B
Contact resistance	5mΩ max.(at 1A 24VDC)
Contact material	AgSnO2
Contact rating (Res. load)	200A 277VAC/28VDC
Max. switching voltage	440VAC
Max. switching current	200A
Max. switching power	55400VA / 5600W
Mechanical endurance	1 x 10 <sup>5</sup> OPS
Electrical endurance	1 x 10 <sup>4</sup> OPS

CHARACTERISTICS

Insulation resistance		1000MΩ (at 500VDC)
Dielectric strength	Between coil & contacts	4000VAC 1min
	Between open contacts	2000VAC 1min
Creepage distance		8mm
Operate time (at nomi. volt.)		30ms max.
Release time (at nomi. volt.)		30ms max.
Shock resistance	Functional	98m/s <sup>2</sup>
	Destructive	980m/s <sup>2</sup>
Vibration resistance		10Hz to 55Hz 1.0mm DA
Humidity		5% to 85% RH
Ambient temperature		-40°C to 85°C
Termination		QC
Unit weight		Approx. 500g
Construction		Dust protected

Notes: The data shown above are initial values.

COIL

Coil power	1 coil latching: Approx. 12W; 2 coils latching: Approx. 24W
------------	--

COIL DATA

at 23°C

Nominal Voltage VDC	Set / Reset Voltage VDC max.	Pulse Duration ms min.	Coil Resistance x (±10%) Ω	
12	9.6	150	Single coil latching	12
24	19.2	150		48
48	38.4	150		190
12	9.6	150	Double coils latching	6+6
24	19.2	150		24+24
48	38.4	150		95+95

Notes: When requiring other nominal voltage, special order allowed.

ORDERING INFORMATION							
	HFE6	-A /	12	-2D	T	2	-R (XXX)
Type							
Version	A: Type A contact terminal B: Type B contact terminal						
Coil voltage	12, 24, 48VDC						
Contact form <sup>1)</sup>	2D: 2 Form B    2H: 2 Form A						
Contact material	T: AgSnO <sub>2</sub>						
Sort	1: 1 coil latching    2: 2 coils latching						
Polarity	R: Negative polarity    Nil: Positive polarity						
Customer special code							

Notes: 1) 2H, 2SH means that relay is on the "reset" status when delivery; 2D, 2SD means that relay is on the "set" status when delivery.If no speical required by customer,we will keep the relay on the "set" status when delivery.

OUTLINE DIMENSIONS AND WIRING DIAGRAM

Unit: mm

Outline Dimensions

Type A contact terminal

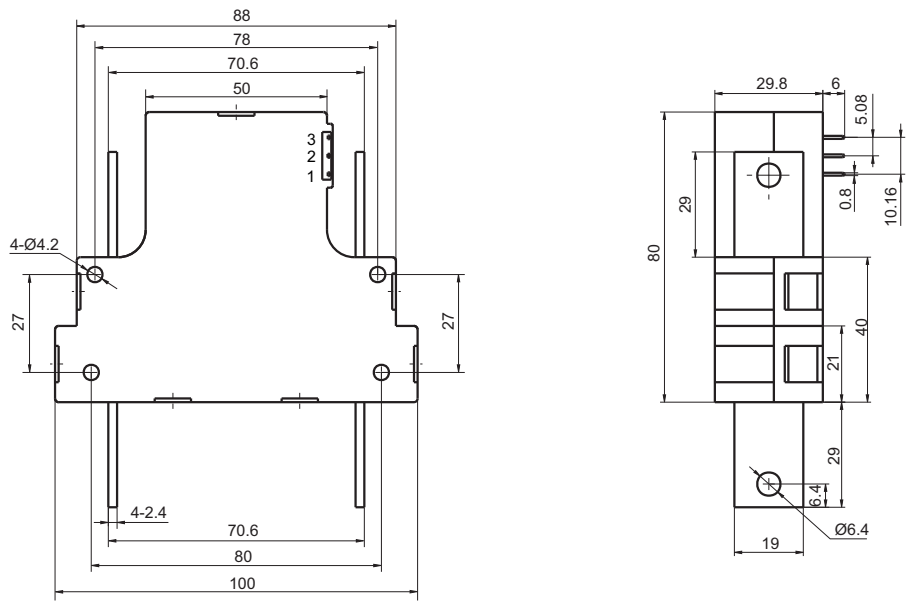

## OUTLINE DIMENSIONS AND WIRING DIAGRAM

Unit: mm

## Outline Dimensions

## Type B contact terminal

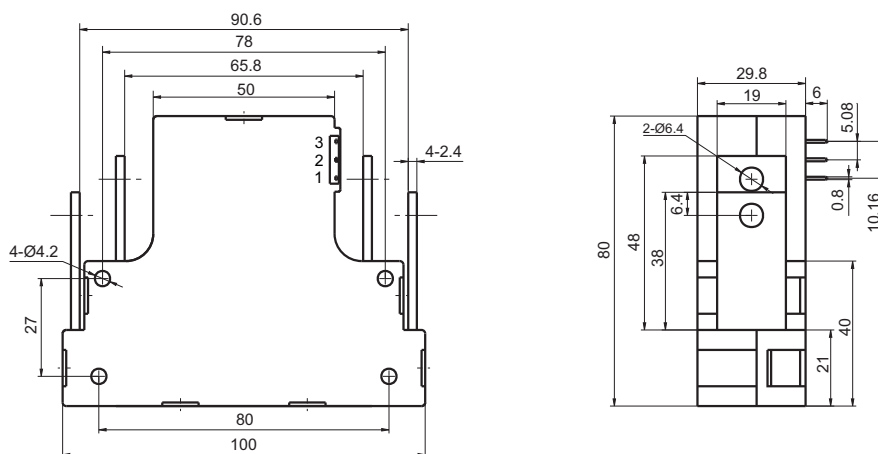

Remark: In case of no tolerance shown in outline dimension: outline dimension  $\leq 1\text{mm}$ , tolerance should be  $\pm 0.2\text{mm}$ ; outline dimension  $> 1\text{mm}$  and  $\leq 5\text{mm}$ , tolerance should be  $\pm 0.3\text{mm}$ ; outline dimension  $> 5\text{mm}$ , tolerance should be  $\pm 0.4\text{mm}$ .

## Coil Wiring Diagram

### Positive polarity

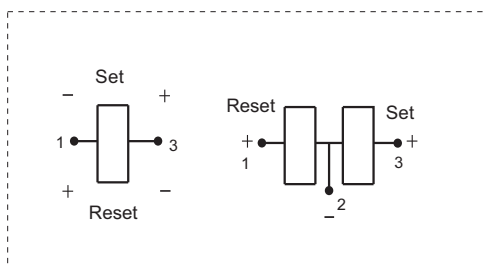

Negative polarity

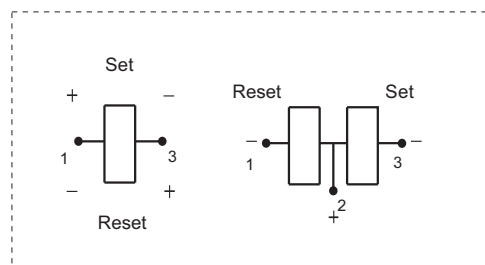

## Notice

1. Relay is on the "reset" or "set" status when being released from stock, with the consideration of shock risen from transit and relay mounting, relay would be changed to "set" or "reset" status, therefore, when application (connecting the power supply), please reset the relay to "set" or "reset" status on request.
2. In order to maintain "set" or "reset" status, energized voltage to coil should reach the rated voltage, impulse width should be 5 times more than "set" or "reset" time. Do not energize voltage to "set" coil and "reset" coil simultaneously. And also long energized time (more than 1 min) should be avoided.
3. The terminals of relay without twisted copper wire can not be tin-soldered, can not be moved willfully.
4. Relays used for metering measuring applications are usually made with dust proof structure, while most relays could be made specially per customer's specific requirements. No longer than 6 months' storage time is recommended for this kind of relay, and please pay attention to the storage environment. To ensure contact reliability, we will keep contact status be closed when delivery if no special required by customer.

## Disclaimer

This datasheet is for the customers' reference. All the specifications are subject to change without notice.

We could not evaluate all the performance and all the parameters for every possible application. Thus the user should be in a right position to choose the suitable product for their own application. If there is any query, please contact Hongfa for the technical service. However, it is the user's responsibility to determine which product should be used only.

© Xiamen Hongfa Electroacoustic Co., Ltd. All rights of Hongfa are reserved.